

Countersunk Hole

Features a countersunk hole through the centre.

Item Code	Outer Dia (D)	Thick (H)	Inner Dia (D1)	Pull Strength
3711	16 mm	5 mm	3.5 mm	5 kg
3713	25 mm	8 mm	3.5 mm	12 kg
3715	42 mm	9 mm	6.5 mm	37 kg

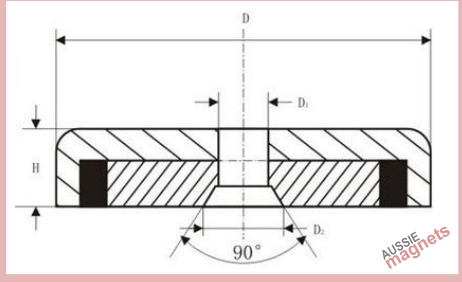

Centre Hole

Features a straight hole through the centre.

Item Code	Outer Dia (D)	Thick (H)	Inner Dia (D1)	Pull Strength
3701	25 mm	8 mm	5.5 mm	14 kg
3703	36 mm	9 mm	6.5 mm	29 kg
3705	60 mm	15 mm	8.5 mm	95 kg
3710	25 mm	11 mm	4.2 mm	11 kg
3790	88 mm	13 mm	18.0 mm	121 kg

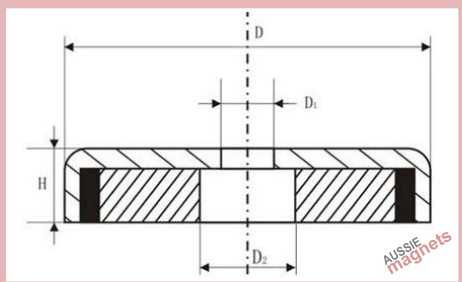

External Boss

Features a threaded boss in the centre of the outer casing.

Item Code	Diameter (D)	Thick (h)	Boss (H - h)	Pull Strength
3747	16 mm	5.0 mm	8 mm	5 kg
3748	25 mm	8.0 mm	8 mm	22 kg
3749	48 mm	11.5 mm	12 mm	81 kg

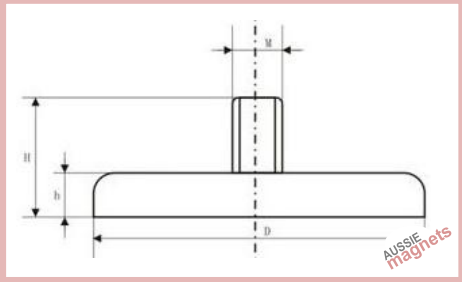

Threaded Post & Removable Hook

Features an outer post with a threaded interior + separate hook.

Item Code	Diameter (D)	Thick (H)	Post (H - h)	Pull Strength
3750	25 mm	7 mm	9.0 mm	21 kg
3760	36 mm	7 mm	9.0 mm	48 kg
3770	60 mm	10 mm	12.5 mm	107 kg

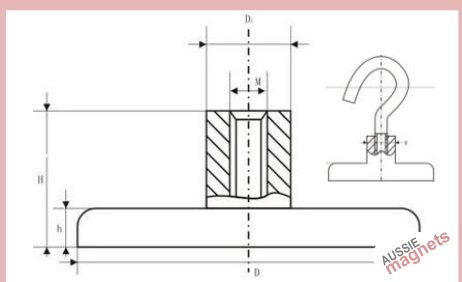

Threaded Hole

Features a threaded centre hole part-way through the unit.

Item Code	Diameter (D)	Thick (H)	Thread (D1)	Pull Strength
3700	20 mm	11 mm	M6	4 kg
3720	35 mm	12 mm	M6	24 kg

