

Countersunk Hole

Features a countersunk hole through the centre.

| Item Code | Outer Dia (D) | Thick (H) | Inner Dia (D1) | Pull Strength |
|-----------|---------------|-----------|----------------|---------------|
| 3711 | 16 mm | 5 mm | 3.5 mm | 5 kg |
| 3713 | 25 mm | 8 mm | 3.5 mm | 12 kg |
| 3715 | 42 mm | 9 mm | 6.5 mm | 37 kg |

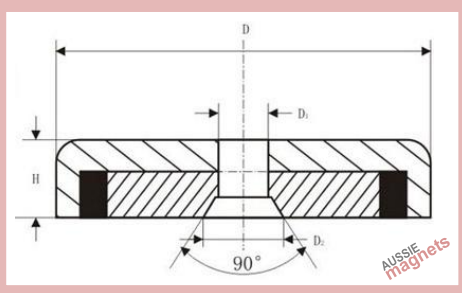

Centre Hole

Features a straight hole through the centre.

| Item Code | Outer Dia (D) | Thick (H) | Inner Dia (D1) | Pull Strength |
|-----------|---------------|-----------|----------------|---------------|
| 3701 | 25 mm | 8 mm | 5.5 mm | 14 kg |
| 3703 | 36 mm | 9 mm | 6.5 mm | 29 kg |
| 3705 | 60 mm | 15 mm | 8.5 mm | 95 kg |
| 3710 | 25 mm | 11 mm | 4.2 mm | 11 kg |
| 3790 | 88 mm | 13 mm | 18.0 mm | 121 kg |

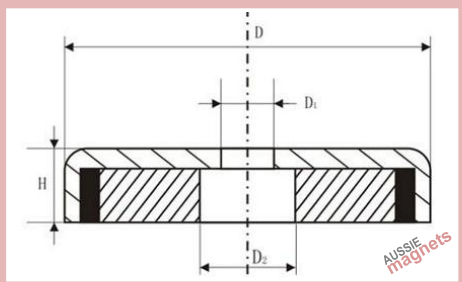

External Boss

Features a threaded boss in the centre of the outer casing.

| Item Code | Diameter (D) | Thick (h) | Boss (H - h) | Pull Strength |
|-----------|--------------|-----------|--------------|---------------|
| 3747 | 16 mm | 5.0 mm | 8 mm | 5 kg |
| 3748 | 25 mm | 8.0 mm | 8 mm | 22 kg |
| 3749 | 48 mm | 11.5 mm | 12 mm | 81 kg |

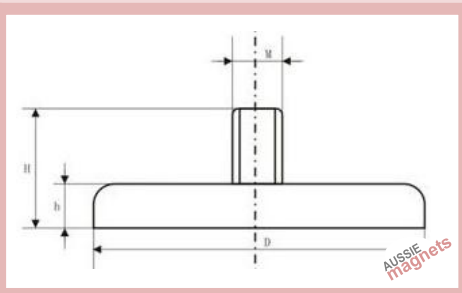

Threaded Post & Removable Hook

Features an outer post with a threaded interior + separate hook.

| Item Code | Diameter (D) | Thick (H) | Post (H - h) | Pull Strength |
|-----------|--------------|-----------|--------------|---------------|
| 3750 | 25 mm | 7 mm | 9.0 mm | 21 kg |
| 3760 | 36 mm | 7 mm | 9.0 mm | 48 kg |
| 3770 | 60 mm | 10 mm | 12.5 mm | 107 kg |

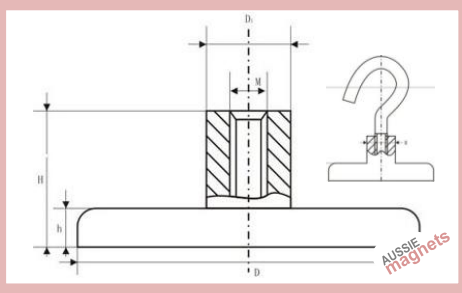

Threaded Hole

Features a threaded centre hole part-way through the unit.

| Item Code | Diameter (D) | Thick (H) | Thread (D1) | Pull Strength |
|-----------|--------------|-----------|-------------|---------------|
| 3700 | 20 mm | 11 mm | M6 | 4 kg |
| 3720 | 35 mm | 12 mm | M6 | 24 kg |

